

Pos	Service code	Description
1	9965 000 28659	Blender coupling
2	9965 000 28660	Motor HV - 220 - 240 V / 50 - 60 Hz
3	4203 035 88780	Housing Black IEC 4.0A
	4203 035 93951	Housing IEC 4.0B
4	4203 035 88230	Airtunnel IEC 5.0
5	4203 035 88240	Switch actuator IEC 5.0
6	4203 035 88390	Safety spring IEC 5.0
7	4203 035 88250	Safety Switch assy A IEC 5.0
8	4203 035 88260	Safety Switch assy B IEC 5.0
9	9965 000 28666	Crimp
10	4203 035 90620	Speed indication window
11	4203 035 88790	PCB HV IEC 5.0
12	4203 035 88880	Bottom
13	9965 000 28684	Cordset EU
	9965 000 28686	Cordset GB
	4203 035 95751	Cordset CN
14	9965 000 28674	Measuring cup
15	4203 035 88830	Jar Lid
16	4203 035 88840	Glass Jar IEC 5.0
17	4203 035 88290	Sealing ring IEC 5.0
18	4203 035 88300	Knife unit IEC 5.0
19	4203 035 90610	Interface IEC 4.0A
	4203 035 93961	Interface IEC 4.0B
	4203 035 88890	Interface IEC 5.0
20	4203 035 88850	Fruitfilter Black IEC 5.0

Please use the parts like below IEC explanation:

IEC 4.0A : Production week till 0813

IEC 4.0B : Production week between 0814 - 0906

IEC 5.0 : Production week from week 0907 onwards

EXPLODED VIEW

HR2084/90 ROW

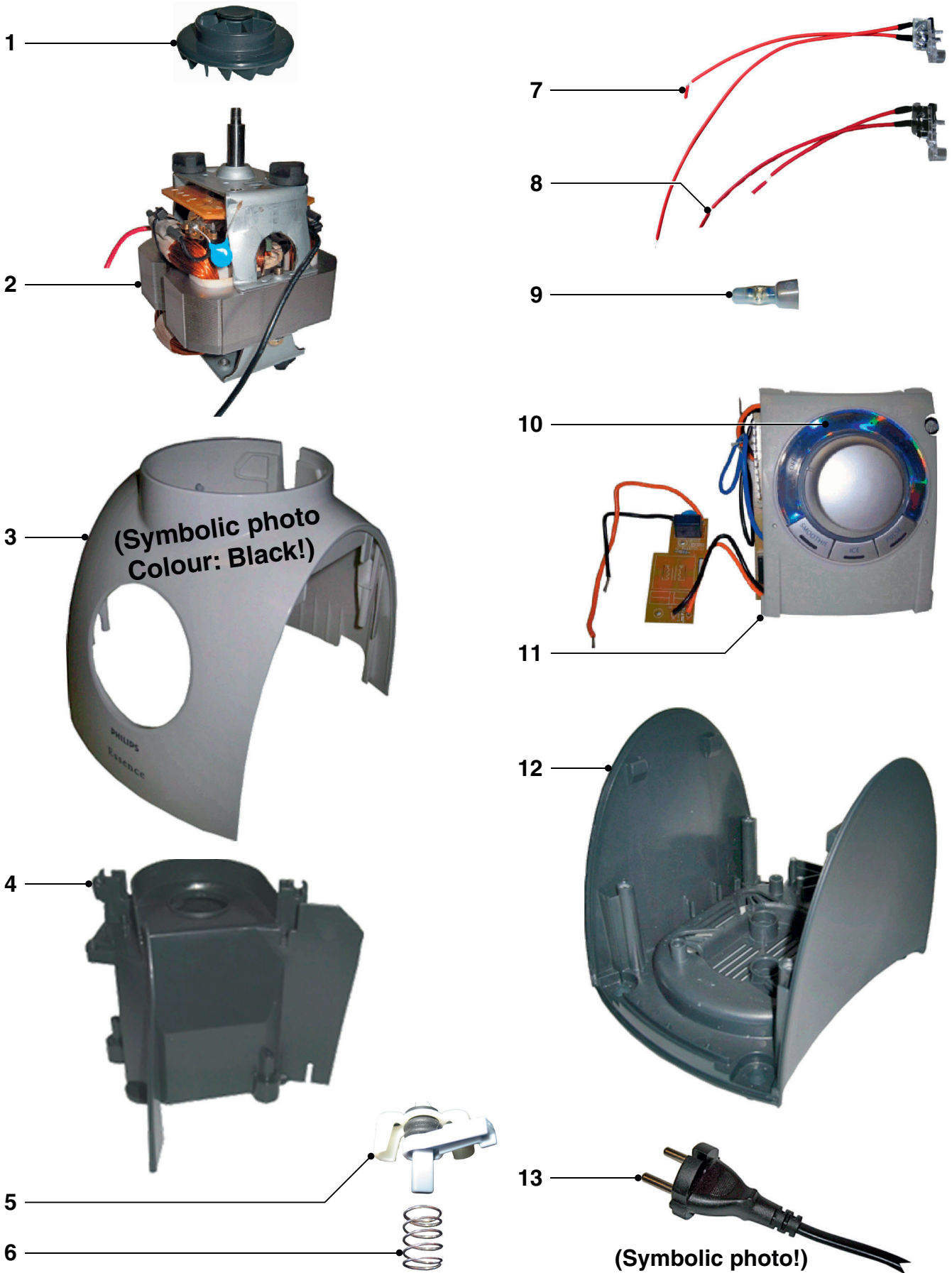

EXPLODED VIEW

HR2084/90 ROW

