

7.5. Gear motor

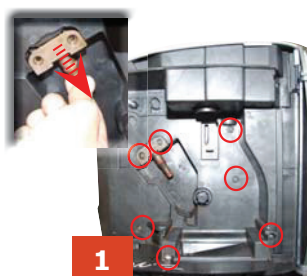

1

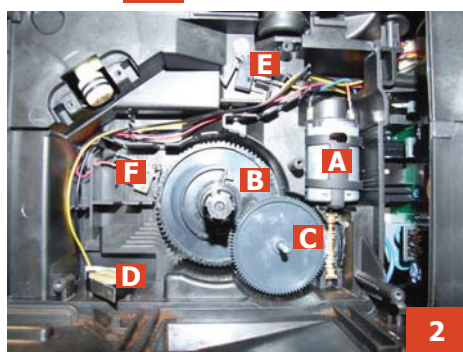

2

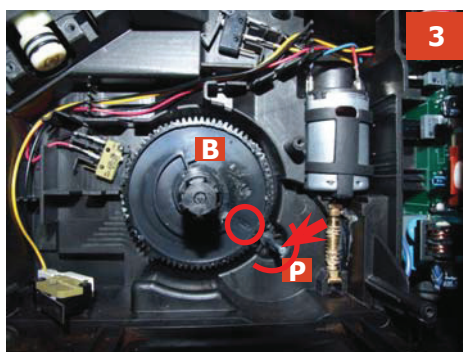

3



5

Gear motor

1) Loosen the screws holding the boiler pin in place, remove it and loosen the other screws shown.

2) The following are located inside the compartment protected by the casing:

- Electric motor (A) with gears (B) and (C) for transmission and timing of the brewing unit.
- Dreg drawer present microswitch (D).
- Brewing unit present microswitch (E).
- Microswitch (F) intercepting the brewing unit home and dispensing phases.
- Remove the gear (C) that meshes with the motor transmission shaft.
- Remove the large gear (B).
- Remove the motor (A), complete with transmission shaft.

3) Replace the gear (B), making sure that the imprint of the arrow is aligned with the opening containing the pin (P).

4) When replacing the motor and the transmission shaft, make sure the guide runners (L) are in the right position. Grease the shaft thoroughly and evenly.