

Cnt-no	Item-no	Quantity	Unit	Name	Specification	Proc.restr.
4	354763	1	piece	Stator	110-120V	
5	343786	1	piece	Rotor	110V-120V	
6	354623	1	piece	Brush holder	100V-120V assy	
8	76561	1	piece	Protective sleeve		
9	73328	1	piece	Supply cord	USA/CDN	
10	72417	2	piece	Conductor end		
11	343179	1	piece	Casing		
12	343169	1	piece	Housing endcap	assy	
13	207960	7	piece	Torx-soc re scr	4X18	
14	240438	2	piece	Int hexalob remf scr	4X45/25 black	
15	343105	1	piece	Seal		
16	76437	2	piece	Plastite screw	45 5X16	
17	201240	2	piece	Int hexalob remf scr	4X35/25 black	
18	26352	4	piece	Torx-soc re scr	3X25	
19	73131	1	piece	Depth gauge		
20	354585	1	piece	Side handle	assy	
28	343351	1	piece	Rating plate	TE 6-S 120V USA	
30	343137	1	piece	Air deflector		
31	343277	1	piece	Motor housing	TE 6-S	
32	240269	1	piece	Labyrinth seal		
33	250693	1	piece	Ball bearing	626-2RSH/C3	
34	343101	1	piece	Bearing plate	assy	
38	201451	1	piece	Spring washer		
39	343750	1	piece	Cooling fan		



HILTI Aktiengesellschaft Schaan/FL
Copyright reserved HILTI = Registered trademark

Spare part list

Item-no	Index	Name	valid as fro	Drawing	Page
343323	6	Rotary hammer drill TE 6-S 120V USA	07.05.04	350076	1 / 4

Cnt-no	Item-no	Quantity	Unit	Name	Specification	Proc.restr.
40	265858	2	piece	Carbon brush 5x8,5x18	100V-120V AO	
42	343395	1	piece	Leaf spring		
43	343168	1	piece	Reversing switch		
44	343159	1	piece	Grip unit		
45	343161	1	piece	Grip cover		
46	277042	1	piece	Switch 100V-120V		
47	343172	1	piece	Air deflector		
48	76586	1	piece	Absorber		
49	75094	1	piece	Clamp		
50	346188	1	piece	Electrical assembly set OHNE ENTSTOERUNG		
51	343513	1	piece	Drive cylinder		
52	343232	1	piece	Striker piston		
53	320021	1	piece	O-ring 13,08X2,62		
54	320036	1	piece	Clevis pin 6M6X20		
55	320161	1	piece	Conrod		
56	320091	1	piece	Shim ring 37X47X1,2		
56	320094	1	piece	Shim ring 37X47X1,5		
56	320096	1	piece	Shim ring 37X47X1,7		
56	320097	1	piece	Shim ring 37X47X1,8		
56	320095	1	piece	Shim ring 37X47X1,6		
56	320093	1	piece	Shim ring 37X47X1,4		
56	320092	1	piece	Shim ring 37X47X1,3		
57	320102	1	piece	Shim ring 43,2X47X1,2		
57	320122	1	piece	Shim ring 43,2X47X1,4		



HILTI Aktiengesellschaft Schaan/FL
Copyright reserved HILTI = Registered trademark

Spare part list

Item-no	Index	Name	valid as fro	Drawing	Page
343323	6	Rotary hammer drill TE 6-S 120V USA	07.05.04	350076	2 / 4

Cnt-no	Item-no	Quantity	Unit	Name	Specification	Proc.restr.
57	320124	1	piece	Shim ring	43,2X47X1,6	
57	320126	1	piece	Shim ring	43,2X47X1,8	
57	320125	1	piece	Shim ring	43,2X47X1,7	
57	320123	1	piece	Shim ring	43,2X47X1,5	
57	320103	1	piece	Shim ring	43,2X47X1,3	
60	76491	1	piece	Rotary shaft seal	AS30X47X7	
61	320052	1	piece	Circlip	X10711-S	
62	343784	1	piece	Gear housing assy		
63	343114	1	piece	Bushing	25X32,6	
64	343116	1	piece	Bevel pinion		
65	320028	1	piece	Ball bearing	8X22X7	
66	343146	1	piece	Feather key	A3X3X16	
67	343228	1	piece	Sheet metal part		
68	343202	1	piece	Circlip	SB22	
69	343143	1	piece	Toothed gear	Z=23	
70	343511	3	piece	Retaining ring	SW8VERSTAERKT	
71	343142	1	piece	Toothed gear	Z=31	
72	343120	1	piece	Eccentric		
73	76227	1	piece	Ball bearing	12X24X6	
74	76791	1	piece	Retaining ring	SW12	
75	343227	1	piece	Sheet metal part		
77	76582	1	piece	Circlip	24X1,2	
78	343121	1	piece	Positioning sleeve		
79	343190	1	piece	Compound gear		



HILTI Aktiengesellschaft Schaan/FL
Copyright reserved HILTI = Registered trademark

Spare part list

Item-no	Index	Name	valid as fro	Drawing	Page
343323	6	Rotary hammer drill TE 6-S 120V USA	07.05.04	350076	3 / 4

Cnt-no	Item-no	Quantity	Unit	Name	Specification	Proc.restr.
80	346151	1	piece	Sleeve		
81	343284	1	piece	Switch assy		
82	343229	1	piece	O-ring 23X1,5		
83	343173	1	piece	Switch		
84	343651	1	piece	Ejot screw 3X18		
85	320022	1	piece	Spring		
86	320056	1	piece	Cap assy		
87	320034	1	piece	Seal FILZ		
88	287485	1	piece	Insert		
90	343141	1	piece	Guide tube		
91	346142	1	piece	Stop		
92	343234	1	piece	Ram		
93	76487	1	piece	Circlip 17X2		
94	343235	1	piece	O-ring 12X2,5		
95	343514	1	piece	O-ring 16X4		
96	76486	3	piece	Retaining ring SW30		
97	76459	1	piece	Ball bearing 61906		
98	320196	1	piece	Washer 39X30,1X2,5		
99	201543	1	piece	Compression spring 4,5X34,8X29		
100	201521	1	piece	Coupling ring		
101	343111	1	piece	Bevel gear		
102	320010	1	piece	Sleeve		
103	320025	1	piece	Retaining ring SW26X3		
819	320560	1	piece	Grease 1KG ALN1001/0		



HILTI Aktiengesellschaft Schaan/FL
Copyright reserved HILTI = Registered trademark

Spare part list

Item-no	Index	Name	valid as fro	Drawing	Page
343323	6	Rotary hammer drill TE 6-S 120V USA	07.05.04	350076	4 / 4

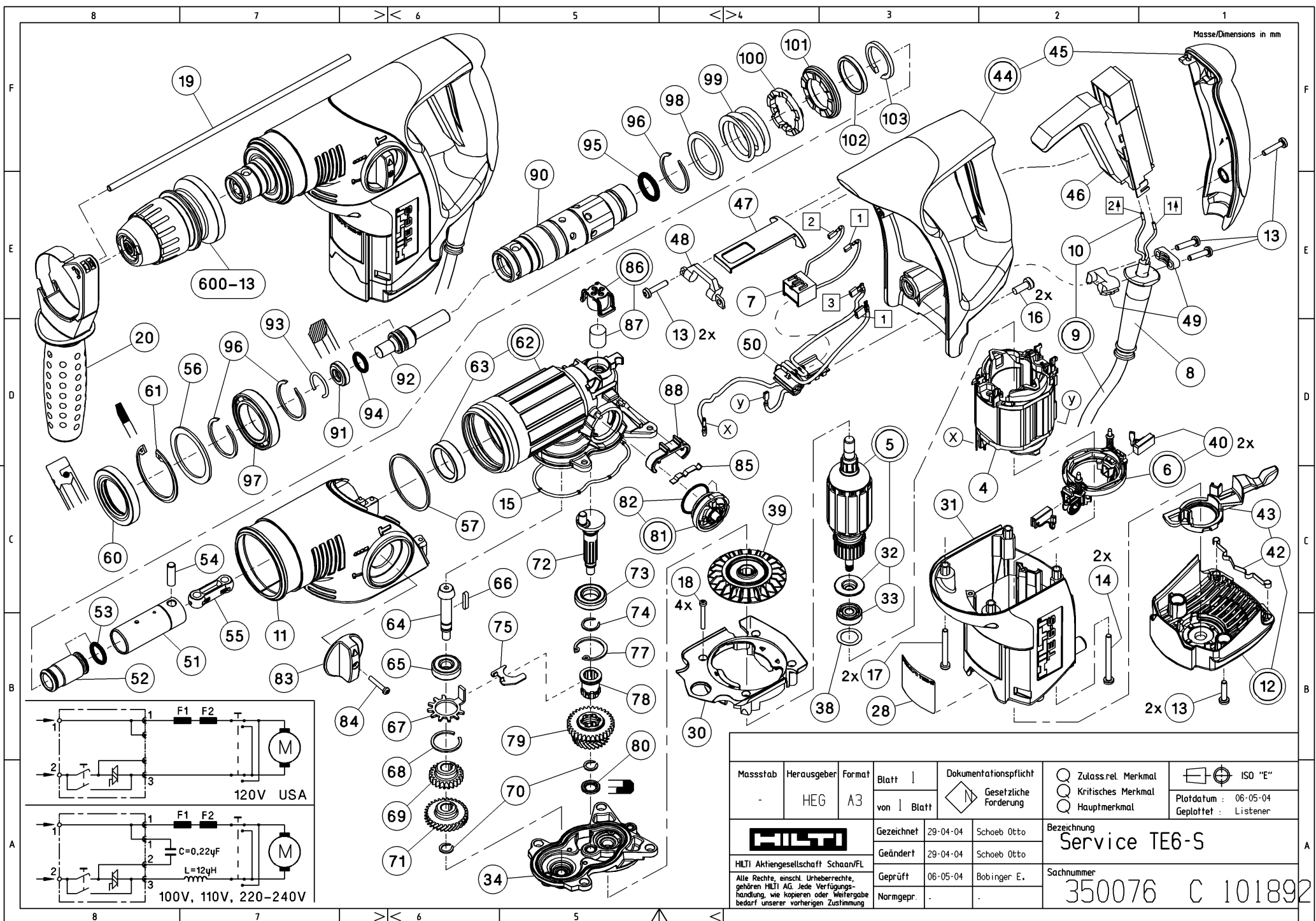

Masstab	Herausgeber	Format	Blatt 1	Dokumentationspflicht	<input type="checkbox"/> Zulass.rel. Merkmal	<input type="checkbox"/> ISO "E"
-	HEG	A3	von 1 Blatt	<input checked="" type="checkbox"/> Gesetzliche Forderung	<input type="checkbox"/> Kritisches Merkmal	Platdatum : 06-05-04
				Gezeichnet	29-04-04	Schoeb Otto
				Geändert	29-04-04	Schoeb Otto
HILTI Aktiengesellschaft Schaan/FL Alle Rechte, einsch. Urheberrechte, gehören HILTI AG. Jede Verfügungshandlung, wie kopieren oder Weitergabe bedarf unserer vorherigen Zustimmung.				Geprüft	06-05-04	Bobinger E.
				Normgepr.	-	-
Bezeichnung					Service TE6-S	
Sachnummer					350076 C 101892	