



Philips Domestic Appliances and Personal Care

Service Manual

PRODUCT INFORMATION

- Colour	: Fresh blue
- Maximum air displacement	: 37 l/sec.
- Maximum vacuum water column	: 310 cm
- Power consumption (IEC) 230 V	: 1400 W
- Duststorage capacity	: 3 L
- Type number dustbag	: FC 8021
- Cord length (depends on version)	: 7 metres
- Filter system	: Paper dustbag : Exhaust AFS air filter : Motor inlet filter
- Dimensions of cleaner	: 460 x 315 x 270 mm
- Dimensions of packaging	: 595 x 395 x 295 mm
- Net weight	: 5.88 kg
- Gross weight	: 9.135 kg

OPTIONAL

- FC 8021	S-bags
- FC 8030	AFS-filter
- FC 8031	HEPA Air Filter
- FC 8034	Upgrade kit Active Carbon Filter
- HR 6988	Turbo brush nozzle
- HR 8040	Polishing nozzle

SERVICE INFORMATION

- Open the appliance, first remove the exhaust filter grille (**item 20**), and then remove the 2 screws - **C** of the switch control panel (**item 15**).

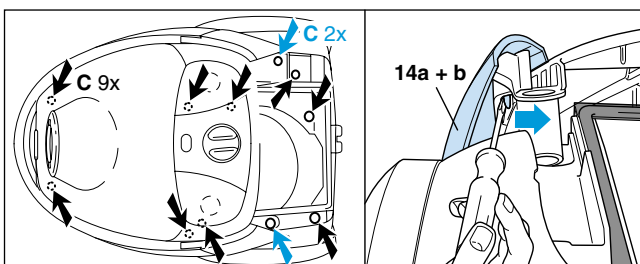

- To remove the the panel, pos 14a + b must be removed by using a screwdriver to separate the two covers from the panel as shown in the picture.
- Undo and remove the 9 screws - **C** in the upper housing (**item 8**). You will require a screwdriver with a 14.5 cm-long shank for this. Screwdriver 9965 000 08332 can be used.
- The component configuration shown in the exploded view may differ in case of specific versions. The components are distinguished by means of code numbers.
- When the repair is finished, check whether all functions of the appliance work properly.
- **Item 4**, cotton dustbag, is used in countries in which paper dustbags are not available.
- To disassemble the cord winder, use TORX screwdriver no.T15, which is one of a set consisting of T20; T15; T10; T9; T8; T7 and T6 (code number 4822 395 50145).
- If the reel half spring unit is replaced, shaft **A** must be lubricated with **silicone grease**. Do not apply any silicone grease to or spill any grease on terminals (**43**) or conductors (**42**).
- **Item 40** is provided with a long cord-winder spring, but both long and short cords can be used in combination with this spring. (L = 9.3 m)
- Depending on the original cord, the spare cord must be shortened to the length of the original cord.
- The cord winder spring must be tensioned to the maximum level and then be rewound approx. 1.5 turn
- **Item 13**, air valve, opens to cool the motor if the air displacement is too low or if the airflow is blocked.
- If the function of the electronic control unit (**item 12**) is not required, the Triac must be short-circuited in the manner shown in the circuit diagram.
- When the vacuum cleaner is used to suck up fine dust the pores of the dustbag may become clogged, causing the passage of air through the dustbag to become obstructed. As a result, the dustbag-full indicator will indicate that the dustbag needs to be replaced, eventhough the dustbag is not full at all.

Pos.	Order code	Description		Pos.	Order code	Description	
1	4322 005 13450	Dust cover	Fresh blue	40	4322 009 07940	Reel half spring unit (L = 9m)	
2	4322 003 18290	Dust cover lock m.grey		41	4322 001 72360	Brake tyre	
3	4322 003 18160	Dustbag holder		42	4322 009 07950	Reel half contact unit	
4	4822 480 10113	S-paper dustbags	FC 8021	43	4322 009 07970	Contact ring plate	
	4322 004 93290	Cotton dustbag		44	4322 006 01440	Argentina	L = 9.3 m
5	4322 003 18300	Cordwinder lever			4322 006 01760	Australia	L = 9.3 m
6	4322 001 73310	Sealing rim		45	4322 006 01680	Taiwan	L = 6.3 m
7	4322 005 12550	Dustbag detector		46	4322 006 01720	U.K. / H.K.	L = 9.3 m
8	4322 003 18060	Upper housing m.grey		47	4322 006 01410	Euro 4.8 mm pins	L = 9.3 m
8a	4322 003 20410	Clamp upper/lower housing		48	4322 006 01670	Swiss	L = 9.3 m
9	4322 000 37300	Triple filter		49	4322 006 01460	Italy	L = 9.3 m
10	4322 009 07040	Grill + triple filter		50	4322 003 18850	C-bend B1	
11	4322 006 21480	Switch soldered version		51	4322 005 13510	C-bend B1 hose assy	
11a	4322 009 08420	Switch lever assy		54	4322 007 16000	Leaf spring assy	
12	4322 006 22560	PCB slide turn 230V		55	4322 004 22570	Plumeau assy	(opt.)
13a	4322 005 12200	Dustbag full indicator		56	4322 003 18870	Crevice nozzle	
13b	4322 005 12210	Air valve		57	4322 005 13410	Acc. bridge assy	
14a	4322 003 19950	Cover R		58	4322 004 41140	Metal tube	(opt.)
14b	4322 003 19940	Cover L		59	4322 004 22610	Telesc. tube	
15	4322 009 08310	Panel assy turn	Fresh blue	60	4322 001 99120	Tube bush	
16	4322 003 17900	Lower housing m.grey		61	4322 007 45550	Tube spring	
18	4322 000 37450	Silencer 4 wall		62	4322 004 22560	Small nozzle	
19	4322 005 12190	Caster assy m.grey		63	4322 004 22740	Nozzle RD262	
20	4322 009 08320	Exhaust grille		64	4322 004 22900	Polishing nozzle	
21	4322 000 37460	Exhaust diffusor		65	4322 005 11040	Polishing disc	
22	4322 004 92910	Electr.static filter	FC 8030	66	8838 041 01010	Polishing brushes	
23	4322 001 73280	Filter sealing		67	9965 000 03349	Coupl. piece (standard)	(opt.)
24	4322 003 18000	S-class sealing		68	4822 358 10205	Drive belt	(opt.)
25	4322 000 37420	Silencer 1 wall		69	4822 479 20201	Brush assy	(opt.)
26	4322 000 37430	Silencer 2 bottom		70	4322 004 22590	Turbo nozzle	(opt.)
27	4322 003 18080	Cord outlet m.grey		A	5322 390 20011	Silicon grease for shaft	
28	4322 003 18910	Rear wheel lock red		B	4322 002 82550	Screw 3.5 x 12 T10	
29	4322 003 20390	Receipt. housing A.C.		C	4322 002 82080	Screw 3.5 x 19	
30	4322 003 17960	Rear wheel m.grey					
31	4322 001 73300	Motor buffer back					
32	4322 003 18040	Inlet sealing					
33	4322 003 18010	Motor cap top					
34	4322 003 18020	ANS disc					
35	4322 001 73290	Motor bufferring front					
36	4322 009 06430	Motor A 1441 230V					
37	4322 000 37440	Silencer 3 ans					
38	4322 003 18030	Motor cap bottom					

This product meets the requirements regarding interference suppression on radio and TV.

After the product has been repaired, it should function properly and has to meet the safety requirements as officially laid down at this moment.

